



HEALTHCARE

*High Performance Flooring
Systems for Healthcare Services*





Healthcare sectors are some of the most demanding environments for floors and floor protection. BioMedical research, pharmaceutical, vivarium and animal holding facilities all have varied and unique needs even within the same building or campus. Consider lobbies, corridors, restrooms & showers, food preparation areas, locker rooms, labs, production areas, equipment cleaning and warehousing to name a few.

ARIZONA POLYMER FLOORING - HIGH PERFORMANCE CONCRETE COATINGS

ABOUT APF

Founded in 1985, Arizona Polymer Flooring (APF) manufactures high-performance flooring products and concrete coating systems for contractors, architects and end users nationwide.

Using advanced polymer chemistry, we have formulated a wide variety of high-quality products based on epoxy, polyurethane and acrylic technology. Every product is field tested for performance and durability using ASTM methods. APF is an industry leader in product research and development, which allows us to offer the most innovative product lines available today.

FLOORING FOR HEALTHCARE SERVICES

APF works with architects and their clients to engineer, design and specify the proper flooring and wall coating systems depending on environmental needs. For more than 30 years, we have been committed to developing the most innovative and practical products on the market. Not only do we manufacture the products, we offer the technical support and the experience it takes to understand the challenges our customers face. By working within our network of installation professionals that specialize in healthcare applications, we provide a team approach to these critical applications, ensuring a successfully completed project. We also invest in the research and development necessary to bring you the most innovative products and systems on the market.

When it comes to protective floor coatings for healthcare facilities, Arizona Polymer Flooring is second to none. APF offers a wide selection of epoxy and urethane cement based flooring systems that meet the stringent environmental demands that are unique to the healthcare industry, including:



Impact and Chemical Resistant



Thermal Shock Resistant



Abrasion Resistant



Low Odor/Low VOC



May Contribute to LEED Certification



Anti-Microbial Additive





Arizona Polymer Flooring has the proven systems and products that provide long lasting protection to meet the demands and requirements of these work spaces. Contact APF's experienced sales and technical service team for specific product and system recommendations.

SEAMLESS WALL COATINGS

APF's Sani-Wall Seamless Wall Coatings offer a durable, sanitary and attractive finish for walls and ceilings in healthcare services applications.

Sani-Wall Systems offer flexible and fiberglass reinforced options and can include rounded wall and corner transitions based on the client's needs. Our Sani-Wall Seamless Wall Coating Systems feature the following benefits:

- Seamless Surface
- Impact and Chemical Resistant
- Abrasion Resistant
- Easily Cleaned
- May Contribute to LEED Certification
- UV Stability
- Resistant to Steam and Sanitizer Exposure
- Anti-Microbial Additive



BIOMEDICAL RESEARCH

Maintain a sterile, sanitary and safe environment with APF floor systems specially designed for biomedical research facilities. Whether designing a BSL Lab or a clean room, our flooring systems can be engineered to perform in any environment and within any cleaning requirements.

RECOMMENDED SYSTEMS FOR BIOMEDICAL RESEARCH FACILITIES

ARMOR - REZ™ HD 135

Armor-Rez HD 135 is a decorative system offering an excellent combination of durability and beauty. It combines a troweled epoxy mortar base that can be topped with a broadcast of vinyl paint chips or broadcast aggregates, and finished with a topcoat of clear epoxy with the option of an additional topcoat of polyurethane. It's typically installed at 1/8th to 3/16th inch thick.

Armor-Rez HD 135 is designed for environments requiring a decorative, heavy duty flooring system, making it an excellent solution for biomedical research facilities.

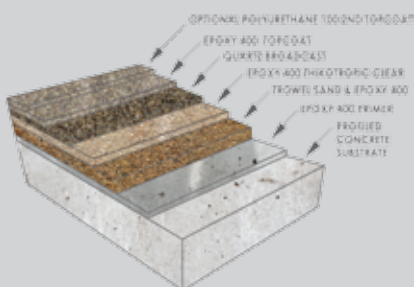

ARMOR - REZ™ SL 100

Armor-Rez SL 100 is a high-build, self-leveling slurry system consisting of a two-component epoxy primer, two-component epoxy slurry and a two-component chemical-resistant polyurethane topcoat.

Armor-Rez SL 100 offers a high gloss, impact resistant floor with excellent chemical and abrasion resistance. It's ideal for floors that are moderately deteriorated.

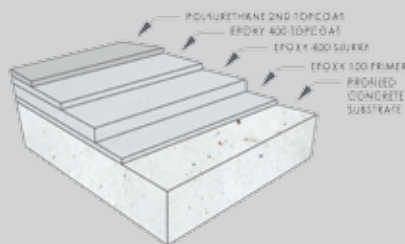

GRANITEX HIGH BUILD

Granitex High Build is a high-build vinyl paint chip flooring system. It provides a durable, easy-to-clean surface that is abrasion, chemical and impact resistant.

Granitex High Build offers a wide range of creative possibilities with unlimited color and size combinations. Larger chips will produce looks similar to terrazzo or granite, while smaller chips produce a hard, carpet-like appearance.

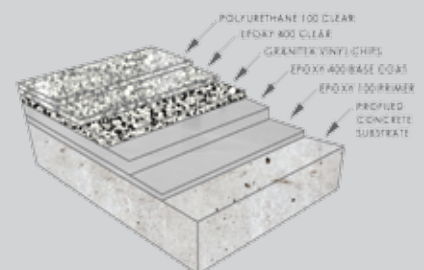



Durability, ease of maintenance and extended lifecycle all add value to your flooring design investment. These systems are available in standard colors, decorative quartz, decorative flake and have an anti-microbial additive option.

COMPLIANCE & PERFORMANCE

SANI - WALL™

Sani-Wall is a high-performance wall coating system that provides a seamless, high gloss, durable and easy-to-clean wall surface. It's installed at 12 to 20 mils dry film thickness, offering a variety of topcoats depending on the application.

Sani-Wall is designed for various institutional and industrial applications, including pharmaceutical, medical and healthcare facilities, biomedical research, vivariums and animal control facilities.

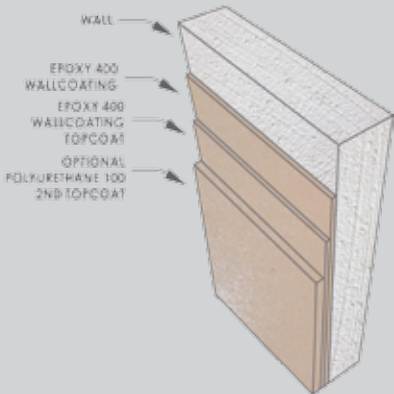

ADDITIONAL SYSTEMS

In addition to these recommended systems, APF offers several systems that are suitable for use in biomedical research applications. For more information on these systems, visit our website at www.apfepoxy.com.

- Armor-Rez CQ 100
- Armor-Rez CQ 150
- Armor-Rez HD
- Armor-Rez CQ 600
- Armor-Rez SL 600
- CastorCrete® SL-B
- Sani-Wall FGR

Arizona Polymer Flooring's systems for biomedical research and life science environments strictly comply with all FDA and GMP requirements as well as with published guidelines of respected design organizations such as The American Institute of Architects (AIA) and the National Institutes of Health (NIH). Our products and systems are seamless, non-absorbent, non-skid, wear-resistant and resistant to the corrosive effects of acids, solvents and detergents. Selection of the right flooring system relates directly to the biosafety level of the building and the level of cleanliness required for the functions performed within the space.

These systems offer continuous, impermeable, easy-to-clean, low-maintenance and long-lasting durability. Our floor and wall coating systems are all engineered to adapt to the most stringent environments and can be fast tracked in order to meet immediate installation needs without sacrificing service or quality requirements.

PHARMACEUTICALS

APF flooring and wall systems are seamless, sanitary, chemical resistant to corrosive sanitizers, resistant to microbial growth, and designed to withstand the severe cleaning regimens typical in pharmaceutical manufacturing. From research laboratories to manufacturing and clean room environments, right down to packaging and shipping areas; Arizona Polymer flooring offers excellent solutions and aesthetically pleasing floor and wall systems while meeting the most stringent installation schedules.

RECOMMENDED SYSTEMS FOR PHARMACEUTICAL FACILITIES

ARMOR - REZ™ BIO FLOOR HDF

Armor-Rez Bio Floor HDF/HDQ has been engineered as a hybrid flooring system consisting of our CastorCrete™ SL urethane cement slurry mortar, our Epoxy 400 as a pigmented basecoat, vinyl flakes or quartz aggregate as a broadcast medium, Epoxy 400 as a grout coat and our Polyurethane 100 VOC as the system topcoat, providing typical installation thicknesses between 3/16th and ½ inch.

Bio Floor HDF/HDQ is available in solid colors as well as in quartz aggregate and vinyl flake matrices.

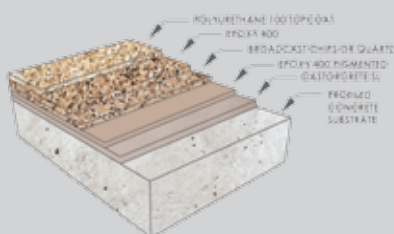
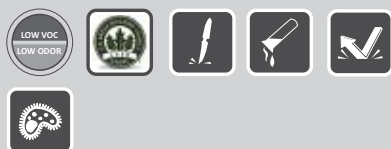

GRANITEX 1 DAY

Granitex 1 Day is a rapid curing, high-build vinyl paint chip flooring system that is based on polyurea/polyaspartic chemistry. It provides a tough, easy-to-clean surface that is abrasion, chemical and impact resistant.

Granitex 1 Day offers a wide range of creative possibilities with unlimited color and size combinations. Larger chips will produce looks similar to terrazzo or granite, while smaller chips produce a hard carpet-like appearance.

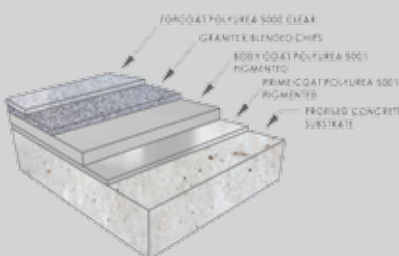

ARMOR - REZ™ SL 100

Armor-Rez SL 100 is a high-build, self-leveling slurry system consisting of a two-component epoxy primer, two-component epoxy slurry and a two-component chemical-resistant polyurethane topcoat.

Armor-Rez SL 100 offers a high gloss, impact resistant floor with excellent chemical and abrasion resistance. It's ideal for floors that are moderately deteriorated.

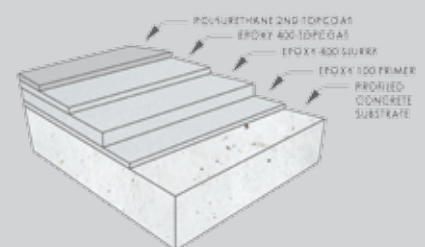



COMPLIANCE & PERFORMANCE

SANI - WALL™ FGR

Sani-Wall FGR is a high performance fiber glass reinforced wall coating system that is typically installed at nominal 25 to 35 mil dry film thickness, offering a variety of topcoats depending on the application. The Sani-Wall FGR system is a seamless, high gloss, durable, impact resistant and easily sanitized wall system.

Sani-Wall FGR is designed for use in various institutional applications, such as pharmaceutical, clean room, healthcare, biomedical research, vivariums and animal control facilities.

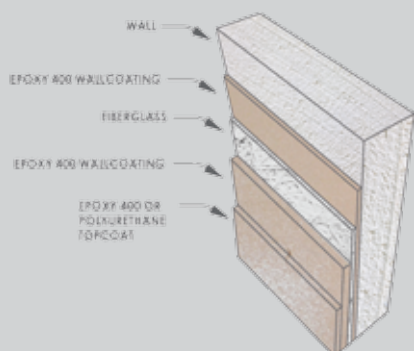

ADDITIONAL SYSTEMS

In addition to these recommended systems, APF offers several systems that are suitable for use in pharmaceutical facility applications. For more information on these systems, visit our website at www.apfepoxy.com.

- Armor-Rez CQ 100
- Armor-Rez CQ 150
- Armor-Rez CQ 600
- Armor-Rez HD
- Armor-Rez HD 135
- Armor-Rez SL 600
- CastorCrete® SL-B
- Granitex High Build
- Sani-Wall
- Stat-Rez PC 350
- Stat-Rez PC 350C

APF offers an array of hygienic, cleanable and anti-microbial coatings for pharmaceutical research and production plants. Critical spaces such as clean rooms, assembly and packaging lines as well as sterile processing areas all require floor coatings that provide a safe and needs-compliant surface.

Our pharmaceutical flooring and wall systems provide the peace of mind that comes from our tested, reliable and high quality floor and wall coating systems.

All systems strictly comply with all FDA and GMP requirements as well as with published guidelines of respected design organizations such as The American Institute of Architects (AIA) and the National Institutes of Health (NIH).

HOSPITALS & INSTITUTIONS

APF offers hospital and institutional clients aesthetically pleasing surfaces that will withstand the heavy traffic and constant cleaning found in the patient areas, corridors and surgical suites, as well as the more industrial environments such as the kitchen and laundry areas. APF products are designed and formulated to accommodate these highly demanding, 24/7 environments.

RECOMMENDED SYSTEMS FOR HOSPITALS & INSTITUTIONS

ARMOR - REZ™ HD 135

Armor-Rez HD 135 is a decorative system offering an excellent combination of durability and beauty. It combines a troweled epoxy mortar base that can be topped with a broadcast of vinyl paint chips or broadcast aggregates, and finished with a topcoat of clear epoxy with the option of an additional topcoat of polyurethane. It's typically installed at 1/8th to 3/16th inch thick.

Armor-Rez HD 135 is designed for environments requiring a decorative, heavy duty flooring system, such as those found in biomedical research facilities.



GRANITEX HIGH BUILD

Granitex High Build is a high-build vinyl paint chip flooring system. It provides a durable, easy-to-clean surface that is abrasion, chemical and impact resistant.

Granitex High Build offers a wide range of creative possibilities with unlimited color and size combinations. Larger chips will produce looks similar to terrazzo or granite, while smaller chips produce a hard carpet-like appearance.



CASTORCRETE® RT - B

CastorCrete® RT-B is a heavy-duty urethane cement mortar applied with a rake and trowel. It's designed to protect existing concrete or resurface moderately deteriorated concrete, while also offering options for a decorative appearance and/or slip resistance with the use of broadcast quartz medium. It can withstand extreme physical exposure including steam cleaning, heavy traffic and heavy impact.

CastorCrete® RT-B has outstanding chemical resistance to most solvents, acids, alkalis, hot oils and animal by-products. This system is typically installed at 3/16 inch to 1/4 inch thickness. It can be sealed with a variety of topcoats depending on environmental exposures and desired aesthetics.

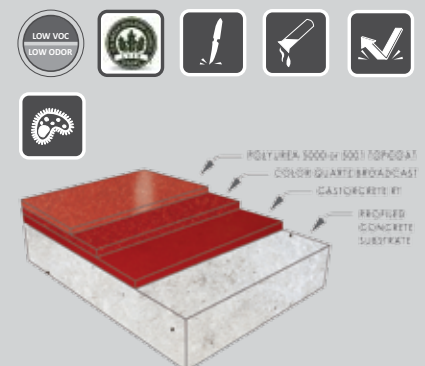



COMPLIANCE & PERFORMANCE

SANI - WALL™

Sani-Wall is a high-performance wall coating system that provides a seamless, high gloss, durable and easy-to-clean wall surface. It's installed at 12 to 20 mils dry film thickness, offering a variety of topcoats depending on the application.

Sani-Wall is designed for various institutional and industrial applications, including pharmaceutical, medical and healthcare facilities, biomedical research, vivariums and animal control facilities.

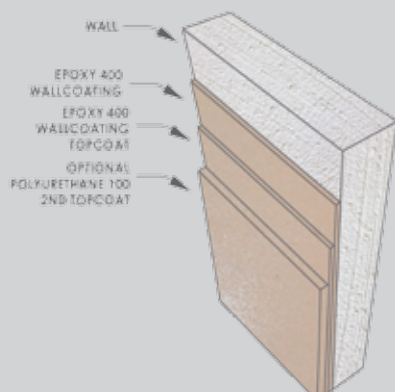

ADDITIONAL SYSTEMS

In addition to these recommended systems, APF offers several systems that are suitable for use in hospital and institutional settings. For more information on these systems, visit our website at www.apfepoxy.com.

- Armor-Rez CQ 100
- Armor-Rez CQ 150
- Sani-Wall FGR
- Stat-Rez PC 350
- Stat-Rez PC 350C

Hospital floors must withstand many hazards, from the continual movement of rolling beds and heavy machines to close contact with a range of chemicals.

APF has a series of flooring systems that are ideal for healthcare environments. They are aesthetically pleasing and impact, abrasion and chemical resistant. Plus, they are seamless, sanitary and easy to clean – all crucial features at a medical facility. If needed, the systems can incorporate an antimicrobial additive.

All systems strictly comply with all FDA and GMP requirements as well as with published guidelines of respected design organizations such as The American Institute of Architects (AIA) and the National Institutes of Health (NIH).

VIVARIUM & ANIMAL HOLDING

Vivarium and animal holding facilities require wall and flooring systems that will provide a stable environment for the animals, technicians and researchers. These are ultimate demand facilities due to the sensitive nature of the environment. APF flooring and seamless wall systems are designed to assist in the maintenance of these demanding environments while ensuring anti-microbial and easy to clean floor and wall surfaces.

RECOMMENDED SYSTEMS FOR VIVARIUM & ANIMAL HOLDING

ARMOR - REZ™ BIO FLOOR HDF

Armor-Rez Bio Floor HDF/HDQ has been engineered as a hybrid flooring system consisting of our CastorCrete™ SL urethane cement slurry mortar, our Epoxy 400 as a pigmented basecoat, vinyl flakes or quartz aggregate as a broadcast medium, Epoxy 400 as a grout coat and our Polyurethane 100 VOC as the system topcoat, providing typical installation thicknesses between 3/16th and 1/2 inch.

Bio Floor HDF/HDQ is available in solid colors as well as in quartz aggregate and vinyl flake matrices.

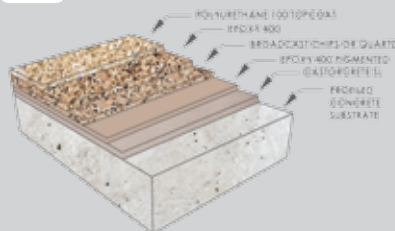
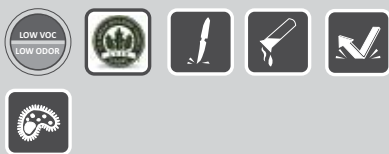

ARMOR - REZ™ HD 135

Armor-Rez HD 135 is a decorative system offering an excellent combination of durability and beauty. It combines a troweled epoxy mortar base that can be topped with a broadcast of vinyl paint chips or broadcast aggregates, and finished with a topcoat of clear epoxy with the option of an additional topcoat of polyurethane. It's typically installed at 1/8th to 3/16th inch thick.

Armor-Rez HD 135 is designed for environments requiring a decorative, heavy duty flooring system, such as those found in biomedical research facilities.

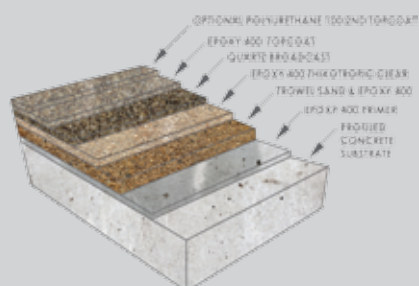

ARMOR-REZ™ SL 100

Armor-Rez SL 100 is a high-build, self-leveling slurry system consisting of a two-component epoxy primer, two-component epoxy slurry and a two-component chemical-resistant polyurethane topcoat.

Armor-Rez SL 100 offers a high gloss, impact resistant floor with excellent chemical and abrasion resistance. It's ideal for floors that are moderately deteriorated.

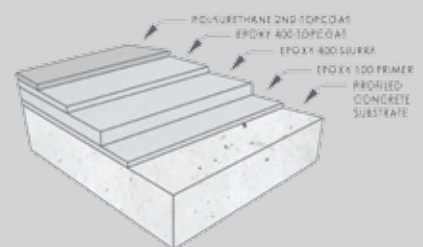



Our flooring systems are able to withstand the intensity and effects of rolling carts and racks, and provide slip resistance for the safety of technicians and their subjects.

COMPLIANCE & PERFORMANCE

SANI - WALL™

Sani-Wall is a high-performance wall coating system that provides a seamless, high gloss, durable and easy-to-clean wall surface. It's installed at 12 to 20 mils dry film thickness, offering a variety of topcoats depending on the application.

Sani-Wall is designed for various institutional and industrial applications, including pharmaceutical, medical and healthcare facilities, biomedical research, vivariums and animal control facilities.

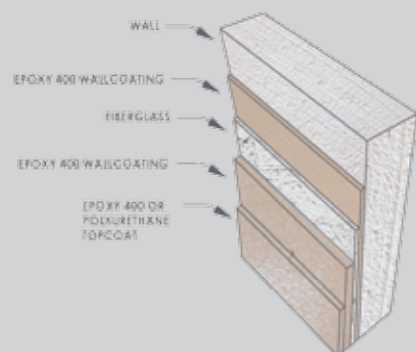

ADDITIONAL SYSTEMS

In addition to these recommended systems, APF offers several systems that are suitable for use in vivarium and animal holding areas. For more information on these systems, visit our website at www.apfepoxy.com.

- Armor-Rez CQ 100
- Armor-Rez CQ 600
- Armor-Rez HD
- Armor-Rez SL 600
- CastorCrete® SL-B
- CastorCrete® RT-B
- Sani-Wall FGR

APF flooring and wall systems are engineered to conform with the recommendations of the Animal Research Strategic Advisory Committee (ARSAC) and the Association for Assessment and Accreditation of Laboratory Animal Care (AAALAC). All systems strictly comply with FDA and GMP requirements as well as the stringent requirements of the American Institute of Architects (AIA) and the National Institutes of Health (NIH).

APF flooring systems are durable and capable of supporting heavy equipment and caging systems. They are also non-absorbent and easily sanitized and can be installed with a smooth or non-slip surface.

APF wall systems are durable, capable of withstanding moderate impact, non-absorbent, seamless and easily sanitized.

APF systems are available with EPA-approved anti-microbial additives.

SYSTEM SELECTION GUIDE

System Name	Market			
	Biomedical Research	Pharmaceuticals	Hospitals & Institutions	Vivarium & Animal Holding
Armor-Rez Bio Floor HDF		✓		✓
Armor-Rez CQ 100	✓	✓	✓	
Armor-Rez CQ 150	✓	✓	✓	
Armor-Rez CQ 600	✓	✓		
Armor-Rez HD		✓		✓
Armor-Rez HD 135	✓	✓	✓	✓
Armor-Rez SL 100	✓			✓
Armor-Rez SL 600	✓	✓		✓
CastorCrete® RT-B			✓	✓
CastorCrete® SL-B	✓	✓		✓
Granitex 1 Day		✓		
Granitex High Build	✓	✓	✓	
Sani-Wall	✓	✓	✓	✓
Sani-Wall FGR	✓	✓	✓	✓
Stat-Rez PC 350		✓	✓	
Stat-Rez PC 350C		✓	✓	



ARIZONA POLYMER FLOORING HIGH PERFORMANCE CONCRETE COATING SYSTEMS



4565 W. Watkins St.
Phoenix, AZ 85043
P: 1-800-562-4921 OR 623-435-2277
F: 623.435.8585 | www.apfepoxy.com